

## INSERTION OF COMFORT INFUSION SETS

This guide is a summary only and intended as a quick reference guide only. Please refer to package insert for full instructions and precautions.

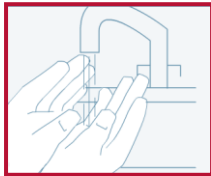

Wash and dry your hands thoroughly.

Thoroughly clean the insertion site and allow to dry. Use of **Adhesive Wipes** will clean the site and help the set to stay in place.

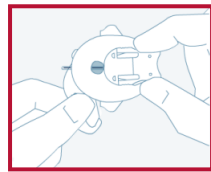

Hold the infusion set with one hand. Gently remove the adhesive backing paper with the other hand.

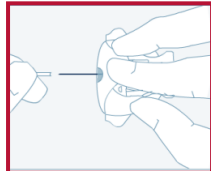

Remove protective sleeve from insertion needle.

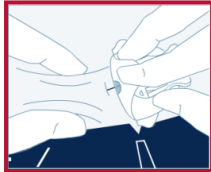

Pinch skin tightly and insert needle on 30 - 45° angle.

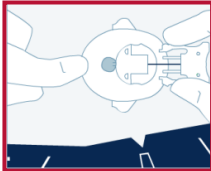

Secure the infusion set with one finger in front of the clear window. Squeeze release section of insertion set by pressing on ridged areas either side of the set.

Remove the insertion needle and dispose of in a sharps container.

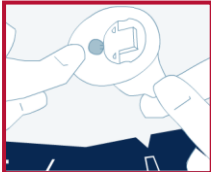

Place one finger in front of the clear window. Gently remove the backing tape from the other half of the site. Hold skin tight and gently press outside of adhesive tape to secure edges.



Connect the line to the cartridge in the pump and prime the line. Ensure there are no air bubbles.

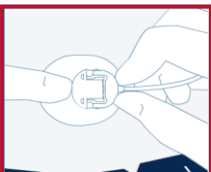

Connect the line to the site and make sure an audible click is heard and fill the cannula.

**REMEMBER TO FILL NEW CANNULA WITH 0.70 UNITS**